

Nozzle clamp for pipe

SCA series



Nozzle Clamp SCA 1 - Thread outlet 1/2"

- Nozzle clamp for one nozzle made in fiberglass reinforced polypropylene for greater robustness.
- Sealing with screws in bichromed iron. Stainless steel available as optional material.
- O-ring in NBR.
- PN16 on all models.
- Suitable for PE and PVC pipe.
- 1/2" outlet thread for nozzle coupling.

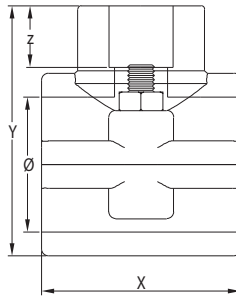

CODE	Ø	X (mm)	Y (mm)	Z (mm)	WEIGHT (g)
20 SCA 1	20	43	48	16	51
25 SCA 1	25	45	52	16	64
32 SCA 1	32	49	60	16	97
40 SCA 1	40	59	72	16	114
50 SCA 1	50	52	81	16	127



Nozzle Clamp SCA 2 - Thread outlet 1/2"

- Nozzle clamp for two nozzles made in fiberglass reinforced polypropylene for greater robustness.
- Sealing with screws in bichromed iron. Stainless steel available as optional material.
- O-ring in NBR.
- PN16 on all models.
- Suitable for PE and PVC pipe.
- 1/2" outlet thread for nozzle coupling.

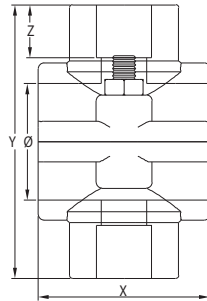

CODE	Ø	X (mm)	Y (mm)	Z (mm)	WEIGHT (g)
20 SCA 2	20	43	63	16	66
25 SCA 2	25	45	71	16	82
32 SCA 2	32	49	84	16	115
40 SCA 2	40	59	92	16	144
50 SCA 2	50	52	100	16	143



RA - Nozzle clamp thread reduction for 1/8", 1/4" and 3/8"

- Nozzle clamp thread reduction for coupling of nozzles of 1/8", 1/4" and 3/8" in brass with external nickel plating.

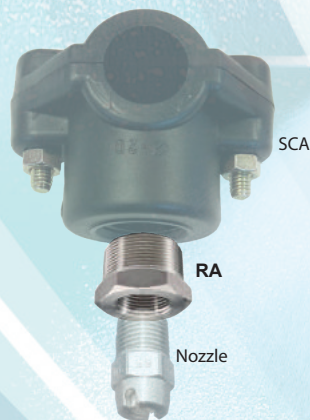

Example of an assembled unit

Product code SCA and RA series

Use this code to place orders.

① Nozzle clamp SCA

〈Example〉 20 SCA 1

20	SCA	1
Ø	Nozzle clamp	For one nozzle
20		■ 1
50		■ 2

② Thread reduction RA

〈Example〉 RA 1/2x1/8

RA	1/2x1/8
Nozzle clamp thread reduction	Thread size
	■ 1/2x1/8
	■ 1/2x1/4
	■ 1/2x3/8

For inquiries / requests for information / quotes related to this product, contact us

IKEUCHI EUROPE B.V.

Merwedeweg 6,
3621 LR Breukelen
The Netherlands

Tel: 0031-20-820-2175

info@ikeuchi.eu



<https://www.ikeuchi.eu>



“The Fog Engineers”
IKEUCHI EUROPE B.V.

“Taking the path less traveled”
「人の足跡を踏むな」

No. IEU191015_SCA_EN